

\*DIVISION OF MURRAYSBURG.

The above Diagram A to L represents the Loan Farm <sup>DE</sup> Hoop with the adjoining farm Spring fontein situated in the \*Graaffreinet District and Veldt Cornetcy of Uitvlugt containing 10,078 Morgens.

Bounded on the North by Hout Kraal & Swavel Kranse  
 S. " Witte Klip  
 E. " Kleinfontein  
 W. " Matjes Kloof

(Sgd.) C. L. Stretch,  
 Landsurveyor.

WHOLE

Quitrent G.R.Q.10-57

25th September, 1841.

Widow of the late B.J.Burger.  
 (Schalk's Son.)

*Schalk's Son*

SD-30.

C

31/10 FARM 30

23:1-1857

M.W./E.B.

OFFICE CO:  
KANTOOR AFSKRIF

S.G. No. 4595/65

SIDES Cape Feet	DIRECTIONS	CO-ORDINATES Lo 25°		OFF. DESIG.
		y	System	
	Constant			
AB	3592.4	312 00 56	A + 260000.0 + 11150000.0	47059-7
BC	3806.3	259 35 30	B + 40295.6 + 37626.6	49464-1
CD	7318.5	236 22 15	C + 33882.9 + 48776.5	
DE	11306.1	4 34 28	D + 27789.2 + 44723.4	
EF	19039.1	74 11 15	E + 28691.0 + 55993.5	
FA	15636.5	205 25 42	F + 47009.6 + 61181.4	
AX	11731.0	132 00 56	X + 49011.4 + 39207.7	
EY	12433.8	4 34 28	Y + 29682.5 + 68387.7	
A'A	1.5	205 25 42	A' + 40296.2 + 47061.0	

Approved.

*H. B. Luth.*  
Surveyor-General.  
20-5-1965

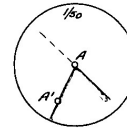

BEACONS:

- A: Not beacons
- A', C, F: Wood and Iron corner fence post, painted and in cairn
- B, X, Y: Iron corner fence post, painted and in cairn
- D: 1/2"x18" Iron peg under cairn
- E: 3' Iron standard projecting 6" under cairn

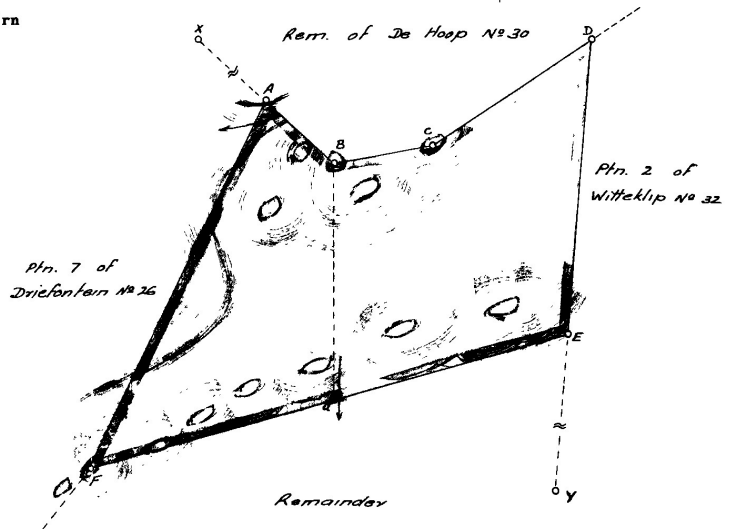

Scale 1: 50,000

The figure A.B.C.D.E.F.

represents 1825.2904 morgen of land, being

PORTION 1 OF THE FARM KLEIN DRIEFONTEIN No. 152

situate in

Administrative District of Murraysburg Province of Cape of Good Hope

Surveyed in February 1965

by me

*H. B. Luth.*  
Land Surveyor.

This diagram is annexed to

D/H No. 7615/65

dated

i.f.o.

Registrar of Deeds.

The original diagram is

No. 4536/1965

Transfer/Grant

No.

File No. Murbg 52

S.R. No. E 793/65

Comp. DM-8, DN-7

Gen. Plan

E. G. Dyer 230/1894

The numerical data of this diagram are sufficiently consistent.  
 No. 230/1894.  
 (Sgt.) J. J. Bosman,  
 Examiner.

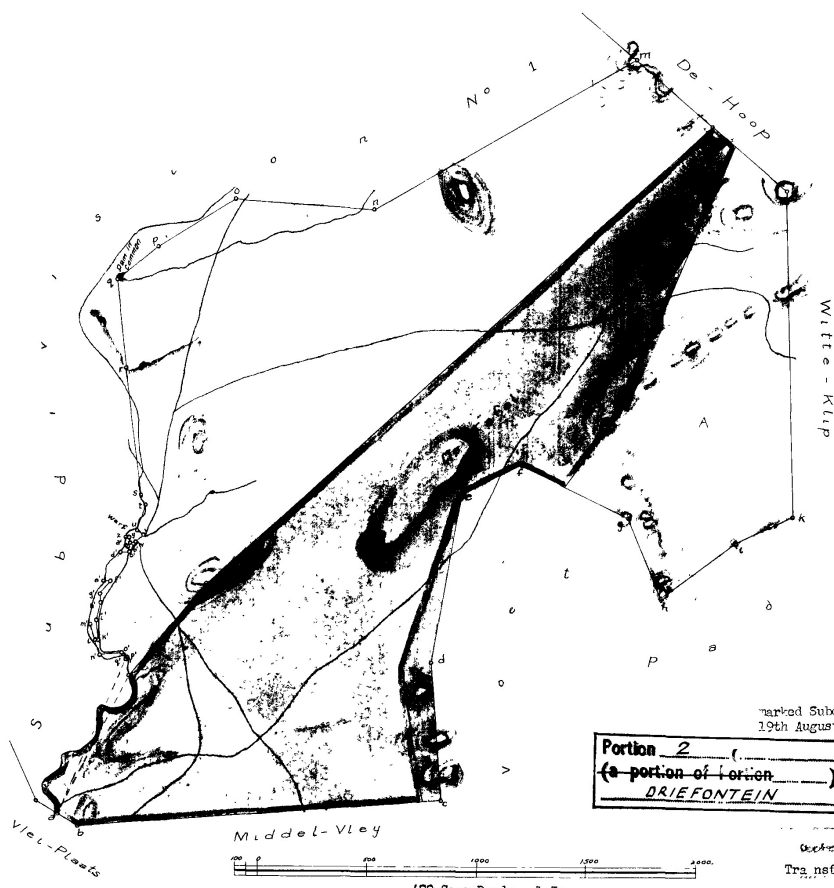

Sides.	Angles.	Co-ordinates.
ab 106.42	a 98.4. 0	a - 2878.59 - 3186.67
bc 1670.20	b 144.37.20	b - 2953.01 - 3262.75
cd 629.21	c 90.4. 0	c - 3213.99 - 4912.44
de 773.81	d 193.32.40	d - 2593.70 - 5017.97
ef 302.24	e 233.34.20	e - 1822.47 - 5322.80
fg 551.74	f 232.47.40	f - 1813.32 - 5617.02
gh 398.52	g 221.30. 0	g - 2164.77 - 6042.35
hi 427.87	h 76.14.40	h - 2558.45 - 6104.24
ik 285.32	i 190.19.20	i - 2393.41 - 6499.00
kl 1473.35	k 114.23.30	k - 2332.30 - 6777.70
lm 911.23	l 131.42. 0	l - 891.28 - 7024.69
mn 1386.07	m 110.27. 0	m - 156.66 - 6545.58
no 633.00	n 213.23. 0	n - 534.63 - 5212.04
op 413.74	o 144. 6.20	o - 34.67 - 4608.53
pq 205.29	p 173.12.30	p - 473.83 - 4215.80
qr 400.12	q 122.22.20	q - 575.87 - 3998.25
rs 580.74	r 178.59.30	r - 972.80 - 3947.80
st 48.18	s 164.16.40	s - 1550.10 - 3884.72
tu 124.85	t 220.52.30	t - 1597.62 - 3892.66
uv 34.14	u 99.20.50	u - 1704.20 - 3827.63
vw 48.09	v 287.55.30	v - 1726.48 - 3853.50
wx 28.27	w 232.41. 0	w - 1751.49 - 3812.43
xy 16.30	x 276.50.20	x - 1741.20 - 3786.10
yz 10.40	y 76.28. 0	y - 1726.83 - 3793.80
za 40.64	z 106.15.50	z - 1724.20 - 3783.74
a'b'	a' 109. 7.50	a' - 1759.07 - 3762.86
b'e'	b' 209.12. 0	b' - 1768.01 - 3770.35
c'd'	c' 291.18. 0	c' - 1788.72 - 3774.29
d'e'	d' 122.23.10	d' - 1780.65 - 3730.93
e'f'	e' 60.58.40	e' - 1890.33 - 3628.90
f'g'	f' 307.58.40	f' - 1897.35 - 3657.25
g'h'	g' 138.50.20	g' - 1942.59 - 3599.58
h'i'	h' 497.22. 0	h' - 1984.14 - 3591.71
i'k'	i' 57.44. 0	i' - 2054.77 - 3554.01
k'l'	k' 289. 4. 0	k' - 2149.15 - 3544.38
l'm'	l' 20.50.20	l' - 2145.09 - 3535.63
m'n'	m' 0.14.40	m' - 2067.24 - 3529.82
n'o'	n' 103.22.20	n' - 2209.05 - 3539.80
o'p'	o' 231. 0.50	o' - 2225.33 - 3638.47
p'q'	p' 283. 1.40	p' - 2253.17 - 3654.31
q'a'	q' 42.54.40	q' - 2256.32 - 3643.75

Area Rectl. Figure = 11646 Morg. 154 Sq. Rods.

The above Diagram a to z a' to q' represents 11659 Morgon and 187 Square Rods, of Ground, marked Subdivision No. 2 of the farm "Driefontein" granted in Quitrent to H.S. and C.J. Burger on the 19th August, 1893. Situate in the Division of Murraysburg, Ward Tromberg.

Portion 2 (a portion of Leren) of the farm DRIEFONTEIN No. 26

Bounded N.Ely. by De Hoop  
 Ely " Witte Klip  
 Ely and Sly " Voetpad  
 Sly " Middel Vley  
 S.Wly " Vlei-Plaats  
 Wly & Wly " Subn. No. 1 and the Remainder, being a common erf, the middle of the River from u to v, z to a', d' to e' m' to n', q' to a being the boundary.

Deed from the Plaintiff relating to Transfer 2083

27th April, 1894.

C. J. Burger.

Sheet D M - 8.  
 SD-26/2

-8-

For list of points and lines of diagram

by me,  
 (Sgt.) A. M. Melville,  
 Sur. Survr.  
 Decr., 1893.

S.S./R.B.

S. G. OSMAN 230/1894

Following list of ...					
No.		Rds.		Date	
434/1895	Post 4 board pink	1892	147	21/5/1895	2747
2200/1914	Set W cold blue	188	463	25/5/1914	2905
855/1917	De-Tafel 1 green	4791	-	12/9/1917	7222



842  
S.G. DGM. NO. 436/1872.

The numerical data of this diagram are sufficiently consistent.  
(Sgd) L. Marquard.  
Examiner.

Sides	Angles
lk 39.57	1 177.51.50
ki 29.49	k 183.33.50
	1 183.4.20

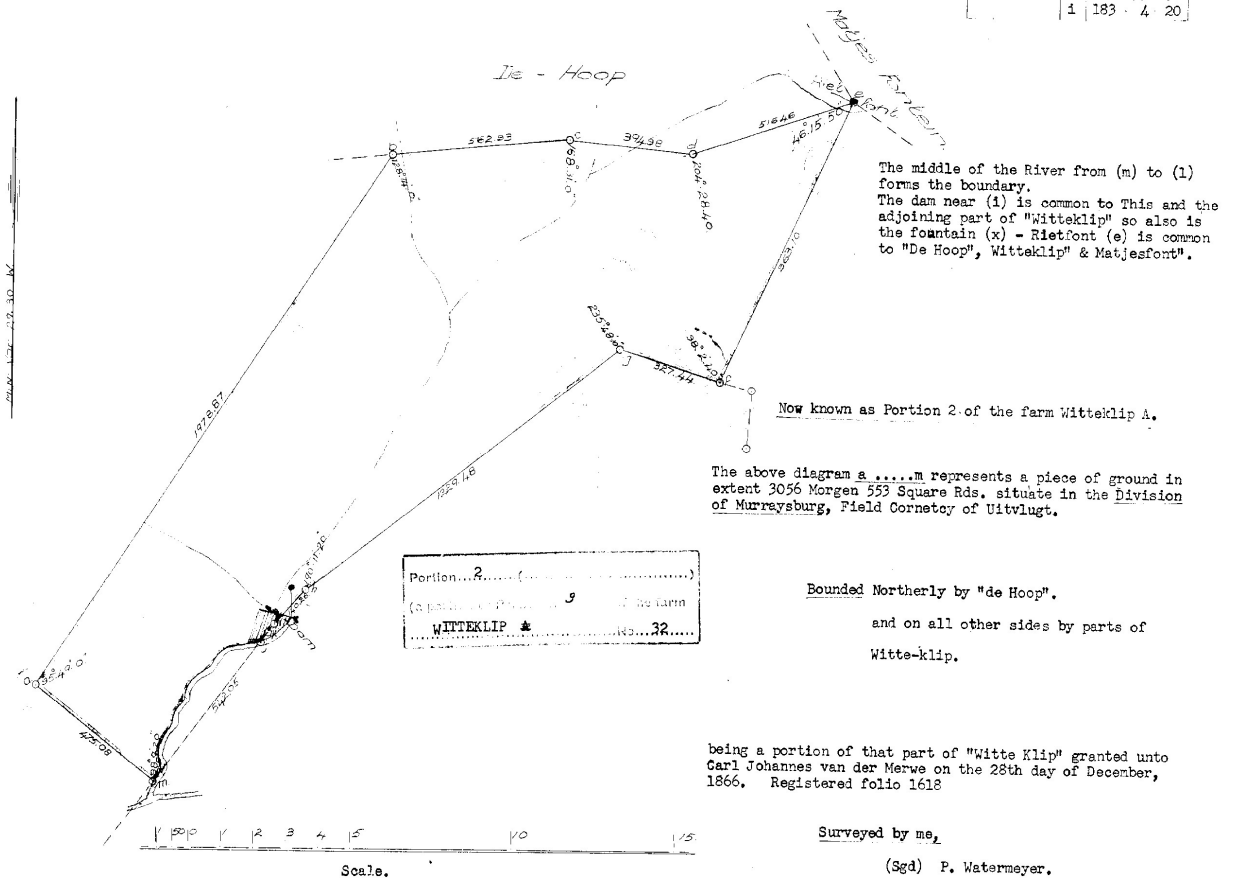

Bounded Northerly by "de Hoop".

and on all other sides by parts of Witte-klip.

being a portion of that part of "Witte Klip" granted unto Carl Johannes van der Merwe on the 28th day of December, 1866. Registered folio 1618

Surveyed by me,

(Sgd) P. Watermeyer.

Government Surveyor.

March, 1872.

V. 163 - 1572

Transfer 101

9th December, 1872.

Jacob Cloete, Hermannus son.

*Retard hope*

23-7-1937

S  
G - 32/2

M.J. B

2001 24 (b), Act No. 4 of 1927.  
S.G. NO. A. 177/45

Approved

*W. Smith*  
Surveyor-General.

T. N.

DESCRIPTION OF BEACONS  
A.B.G. : 18"x1" Iron peg under cairn.  
C.D.E. : Fence post marked with paint with cairn round base.  
F. : 2'x1" peg under cairn.

SIDES Cape Feet	ANGLES OF DIRECTION	COORDINATES.	
		SYSTEM	Lo 25
AB	10609.9	292 41 57 A	Const. +270000.0 +11100000.0
BC	1582.4	43 22 30 B	Const. +270000.0 +11100000.0
CD	2516.4	67 47 0 C	+ 16471.4 + 83940.5
DE	2069.3	180 55 10 D	+ 6683.3 + 88034.8
EF	10871.3	64 54 27 E	+ 7770.1 + 89185.0
FG	5943.8	139 34 10 F	+ 10099.7 + 90136.5
GA	8424.3	2359 59 46 G	+ 10066.5 + 88067.5
			+ 19911.8 + 92677.8
			+ 23766.6 + 88153.5

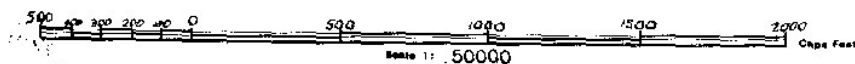
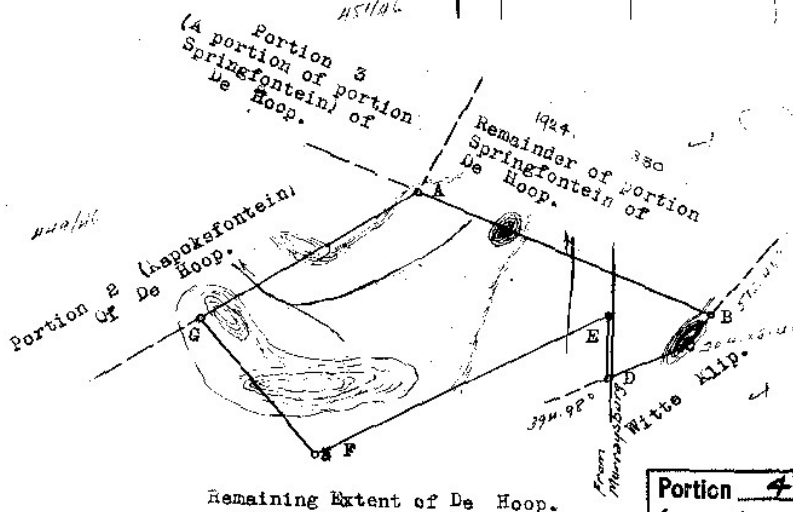

The figure A.B.C.D.E.F.G.

823,0445 Morgen of land, being Portion 4

represents  
of the farm

DE HOOP

situate in the ~~Division~~ Division of MURHAYSBURG.

Surveyed in OCTOBER 1945

by me

PROVINCE of ~~TRANSVAAL~~ CAPE OF GOOD HOPE.

Land Surveyor.

This diagram relates to Deed of *Transfer*  
No. 16528 dated 25.9.46.  
in favour of J. O. Rinaar  
Registrar of Deeds.

The original diagram is No. 209/1865.  
annexed to Deed of *Gift*  
No. M. Q. 121 dated 17/7/1865.  
in favour of H. S. Burger.

S.D. File No. *5464575*  
Survey Records No. *E-139/46*  
Compilation No.  
Lat. South Long. East  
*M. L. 1. 1. 1.*  
*O.N. 7.*  
*ON-7. N.*

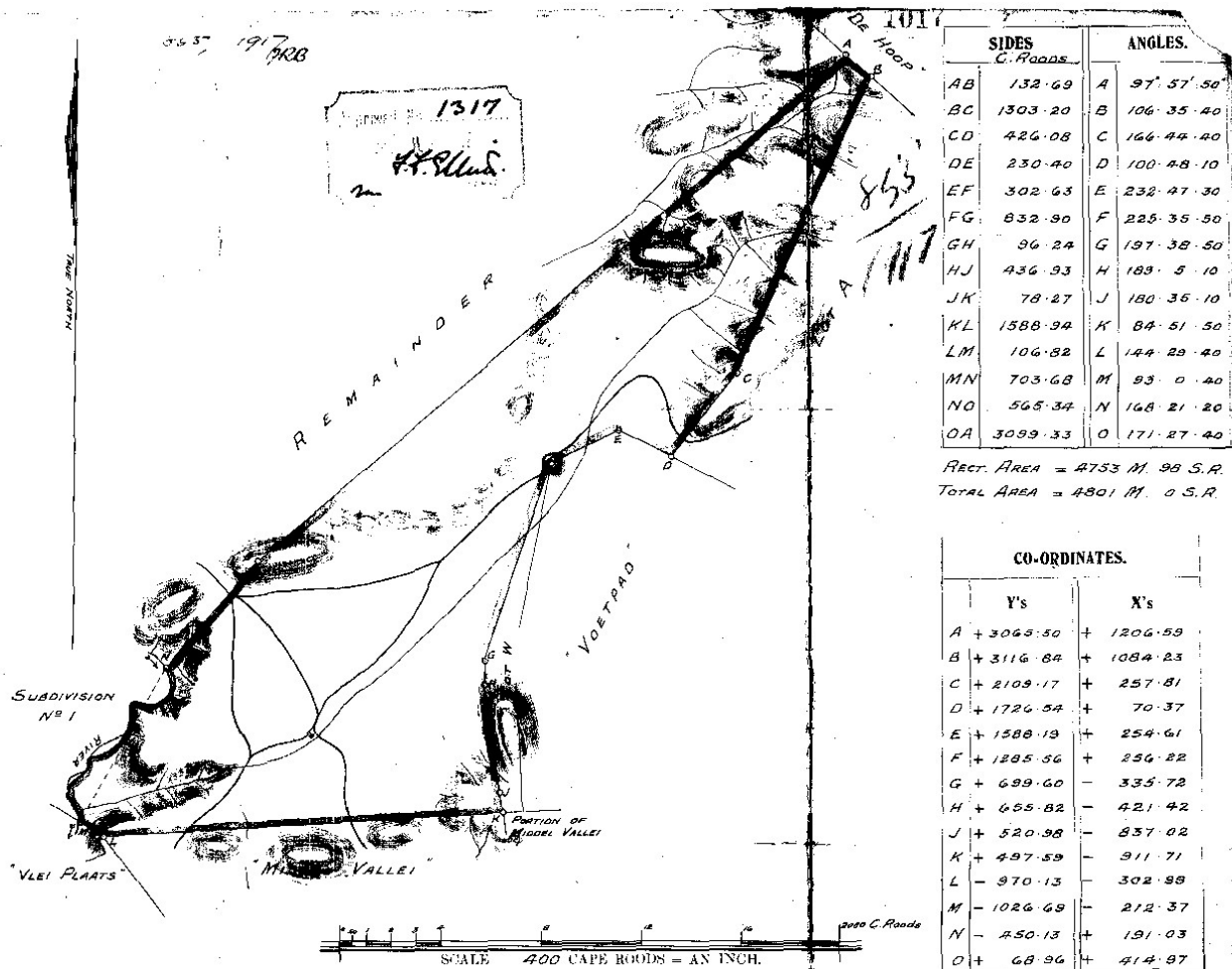

The above diagram lettered A B C D E F G H J K L M middle of River N.O. 1  
Represents 4751 Morgen 0 Sq. Rds. of land situated in the Division of Murraysburg, F.C. Trowberg  
being DE TAFEL portion of Subdivision N<sup>o</sup> 2 of the farm DRIEFONTEIN transferred to  
C. J. Burger on 27<sup>th</sup> April 1894

Bounded S.E. wards by "Voetpad" & Lot A  
S.W. wards "Voetpad" & "Vlei Plats"  
Bounded N.W. wards by "De Hoop"

Portion 7 (a portion of Portion 2) of the farm DRIEFONTEIN No. 25

S " " Middel Valley  
B " " Lot W  
N.W. " " Remainder & middle of River from M. to N.

Surveyed and Leased by me according to Regulations.

May 1917.

Frank W. Porter  
Government Land Surveyor.

This Diagram belongs to the Transfer made  
this 1<sup>st</sup> day of Feb 1917  
in favor of J. H. L. Lock  
CHIEF CLERK.

SD-26/7

C S B

# SERVITUDE DIAGRAM

SIDES Metres		ANGLES OF DIRECTION		CO-ORDINATES Y System : WG 23 X		S.G. No.
		Constants:		0,00	+3 000 000,00	6627/2007
AB	2460,61	34 02 14	A	- 40 102,87	+ 506 441,73	Approved  for SURVEYOR- GENERAL 4-12-2007
BC	12168,10	28 29 32	B	- 38 725,59	+ 508 480,77	
			C	- 32 920,92	+ 519 175,09	
CROSSROADS GABRIELSBAKEN		156	Δ	- 39 811,02	+ 513 039,53	
		159	Δ	- 30 037,49	+ 511 332,37	

## BEACON DESCRIPTIONS

A,B : 16mm Iron peg

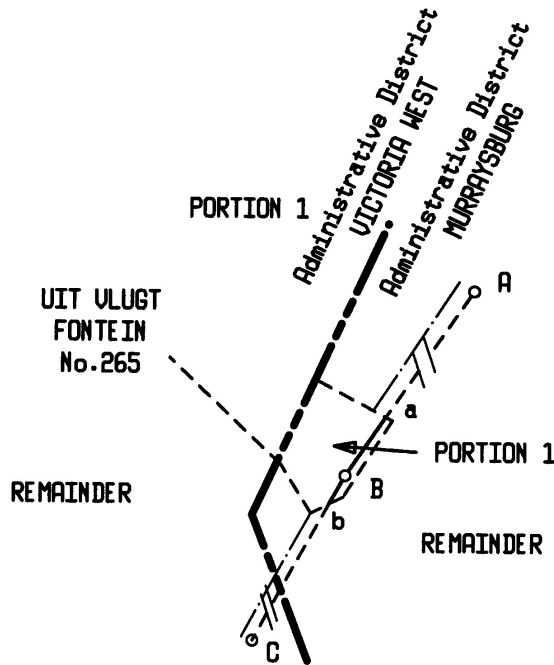

SCALE 1 / 50 000

The Line a B b represents the centre line of a Electric Power Transmission Servitude 55,00 metres wide over

Portion 1 of The farm SCHIETKUIL No. 3

Administrative District : MURRAYSBURG

Province : Western Cape

Surveyed in April 2007 by me

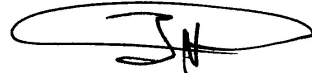
  
(H.T. NDHLOVU) (PLS 1058)  
Professional Land Surveyor

This diagram is annexed to  
Deed of Servitude No.

The original diagram is  
S.G. No. 9009/1967

File Murbg. 3 V.1  
S.R. No. E2796/2007

d.d.  
i.f.o

Transfer No. 1968- 19510  
Grant

LPI C0520000  
Comp.

Registrar of Deeds

Gen Plan

SERVITUDE DOM.

6627/2007

EXEMPT FROM PROVISIONS OF ACT  
70 OF 1970

SECTION 2(9)

EXEMPT FROM PROVISIONS OF  
CHAPTER III OF ORD. 15/1985

SYE Meter		RIGTINGS- HOEKE	KOÖRDINATE Stelsel Lo 23° X			L.G.No.
		Konstante	±	0,00	+3 000 000,00	2418-86
AB	6 110,21	26.02.31	A	- 41 280,17	+ 502 251,85	Goedgekeur <i>R.A.T.</i> nms. Landmeter- generaal 1986-04-24
BC	299,86	28.14.43	B	- 38 597,62	+ 507 741,71	
CD	8 140,89	35.50.26	C	- 38 455,71	+ 508 005,87	
			D	- 33 688,97	+ 514 605,28	
EF	5 908,46	32.42.18	E	- 42 058,71	+ 502 914,74	
FG	299,97	28.20.25	F	- 38 866,29	+ 507 886,49	
GH	14 825,80	28.29.41	G	- 38 723,89	+ 508 150,51	
			H	- 31 650,80	+ 521 180,31	
Bulberg II		▲ 18		- 35 391,17	+ 500 700,52	
Nieuwerust		▲ 57		- 34 565,34	+ 516 979,11	

Bakenbeskrywing

A, B, C, D, E, F, G, H : 20mm Ysterpen in basis van kragtoring

Die omvang en wydte van die Serwitute is 23,50 meters aan albei kante van die lyne ab, cd, ef en gh, jk, lm.

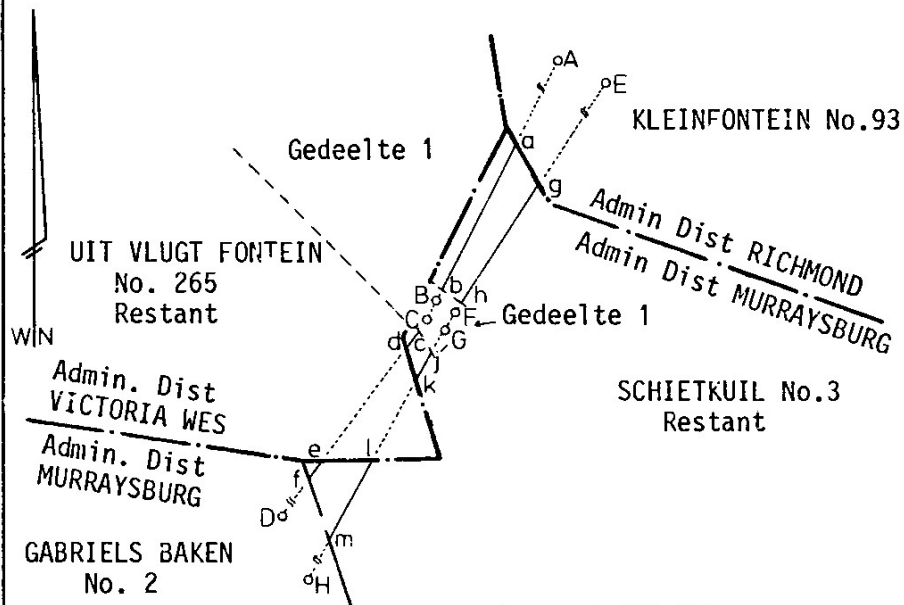

Skaal:- 1:100 000

Die lyne ab, cd, ef en gh, jk, lm

stel voor die hartlyne van 'n Serwitute van Elektriese Kragleidings oor

Die Restant van die plaas

SCHIETKUIL No. 3

geleë in die Administratiewe Distrik Murraysburg

Opgemeet in Augustus 1985

Provinsie KAAP DIE GOEIE HOOP

deur my

A.W. Reynolds Landmeter

Hierdie kaart is geheg aan

Akte van Serwitute No. K799/87

gedateer t.g.v.

EVKOM

Registrateur van Aktes

Die oorspronklike Kaart is

No. 3/1889

Transport/Grondbrief

No. Mu Q 2-6

Lêer Numbg. M.F.

M.S. No. E3104/85

Komp. No. DM-5(5013)

Alg. Plan

The farm  
MUSKIETKRAAL No. 3  
MURRAYSBURG

The annexed diagram represents the farm Muskeit Kraal situated in the Field Cornetcy of Uit Vlucht, Graaff-Reinet District, Containing 9938 Morgens.

Bounded as Described, viz.

North	Uitvlugtsfontein
South	Losse Kop
East	Kleinfontein, and
West	Gabriels Baken and Mandant Klassens Kraal.

Surveyed by  
(Sgd.) C.L. Stretch.  
Land surveyor.

for Barend Burgers 13 June 1827

Copied from diagram relating to  
D/G G.R.Q. 8-41

DM-5 (5013)

*W77 in red*  
for Surveyor-General  
Date 1992.04.13

DC

**CANCELLED**  
VIDE Form 3 (Mu.Q2-6)  
SURVEYOR-GENERAL

S.G Dgm No 284/1827

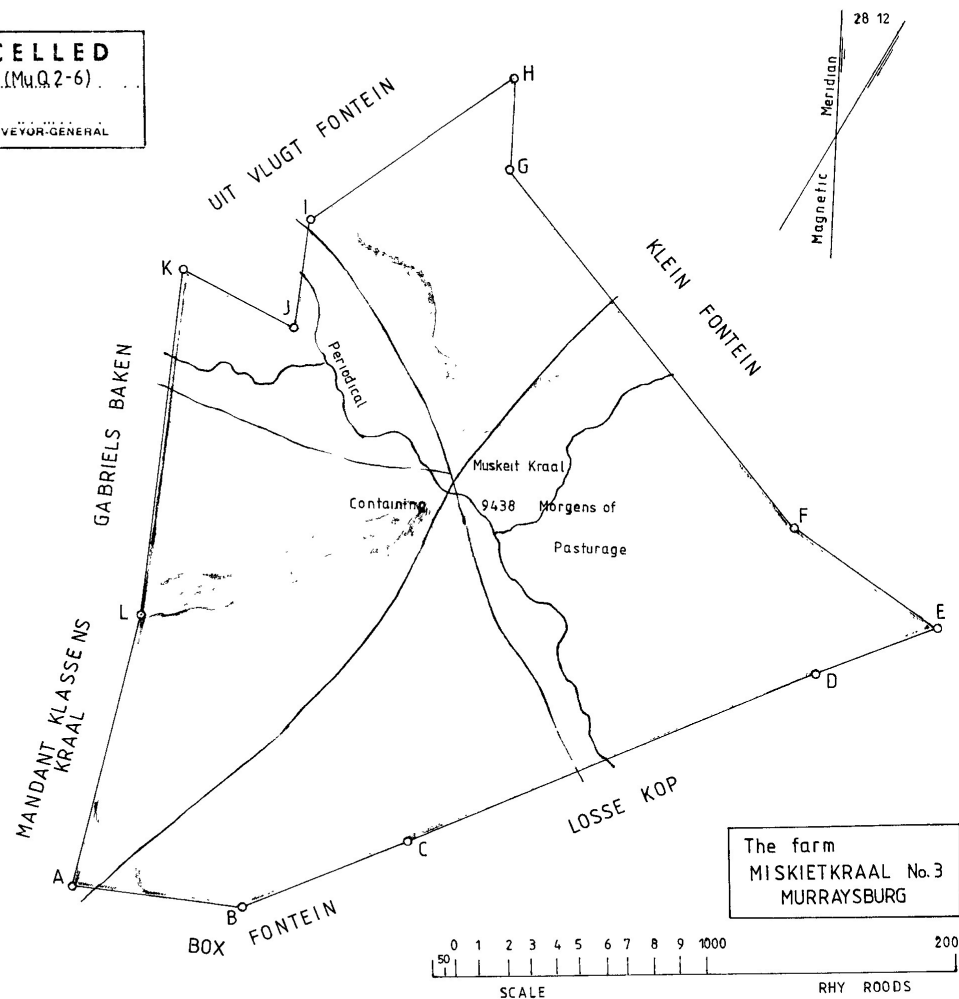

S. G. DEPT. NO. 3/1889.

The numerical data of this diagram are sufficiently consistent.  
(Sgt.) Max Jurisch,  
Examiner.

B.A. 003/1889

Sides. Cape Roads.		Angles. o ' "	Co-ordinates.	
			Y.	X.
AB	495.32	A 72. 32. 00	A + 448.61	+ 209.99
BC	444.90	B 285. 54. 10	B - 0.00	- 0.00
CD	891.66	C 137. 54. 40	C + 291.80	- 335.84
DE	342.33	D 54. 27. 10	D + 274.65	- 1227.34
EF	1923.93	E 221. 47. 00	E - 0.00	- 1023.00
FG	662.68	F 190. 37. 00	F - 1916.21	- 1195.14
GH	676.83	G 60. 53. 30	G - 2554.01	- 1375.02
HJ	1729.74	H 180. 00. 00	H - 2397.64	- 716.50
JK	779.79	J 176. 19. 50	J - 1998.02	+ 966.44
KL	668.40	K 145. 56. 30	K - 1769.68	+ 1712.05
LM	1125.37	L 91. 09. 30	L - 1249.60	+ 2131.92
MA	1439.90	M 182. 28. 40	M - 525.13	+ 1270.75

The above diagram A. B. C. D. E. F. G. H. J. K. L. M. A. bordered green, represents 10527 Morgen, 265 Sq. Roads of Land, situate in the Field-Corsetry of Uitvlugt, in the Division of Murraysburg.

Extending South-Eastwards. to Klein Los Kop, Los Kop & Boksfontein.  
North-Eastwards. " KLEINEFONTEIN.  
Westwards. " MORDANT -KLAASSENS-KRAAL & GABRIELS  
North-Westwards. " BAKEN. & UITVLUGTSFONTEIN.

Being the farm SCHIETKUIL (alias MISKIETKRAAL, originally granted to Barend Burgers (B. son.) on the 1st. Sept. 1837, (Registered folio 499 Audit Off. ) & last transferred to Cornelis Johannes Hugo on the 31st December 1873.

Resurveyed in terms of the provisions of Act No. 9 of 1879, by me,

(Sgt.) M. P. Aurret,  
Govt. Land Surveyor.  
June 1888.

The farm...SCHIETKUIL.....No. 3.....

Captd from the original survey  
Quilant...Title Deed...M. Q. 2-6.  
Gtd. 21st May 1889.

C. J. Hugo.

SD-3.  
Sheet DM-6.  
Sheet DM-5 SHEET DM-7.

B  
S

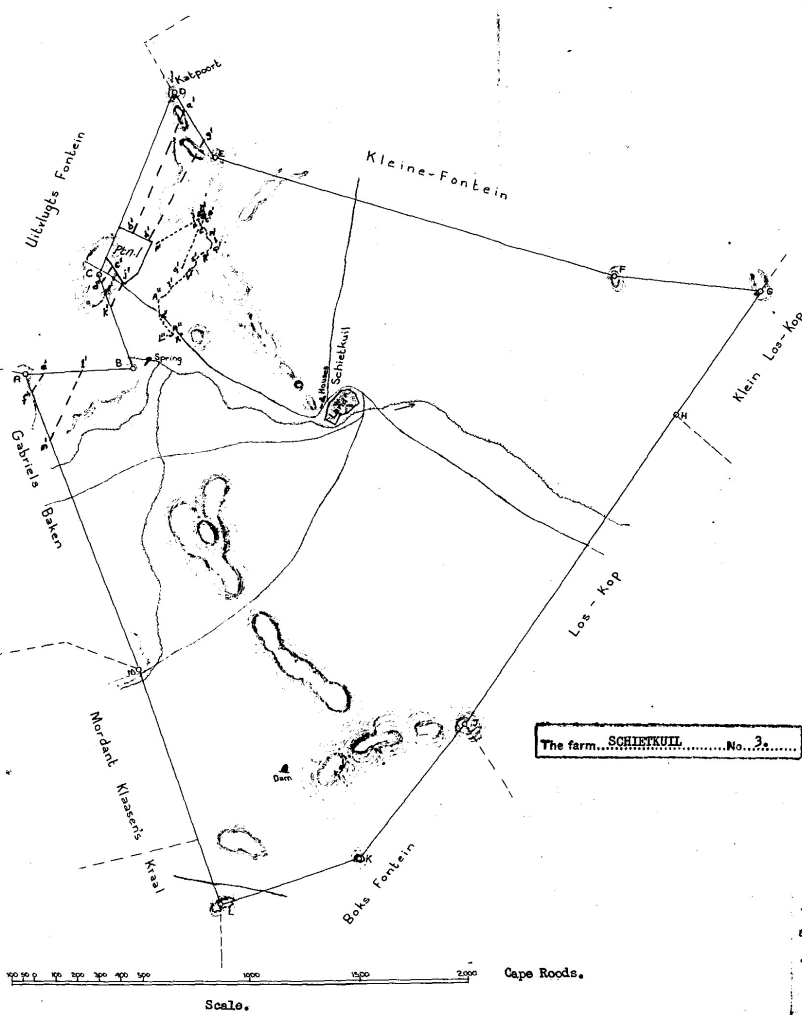

58871889

SURVEY RECORD	DIAGRAM NO.	DESCRIPTION	DEED	INITIALED
E. 108/79	34-77/79	The Figure A'B'C'D' represents a servitude area. E'F' & E'G' represent the centre lines of servitudes 20m wide. The line lettered H'I'K'L'M' N'O'P'Q'R'S'T'U'V'W'X'Y'Z' A'B'C'D'E'F'G'H'I'J'K'L' represents the Western North Western boundaries of a servitude of Right of way 6 metres wide.	K102/80S K.102/80 <sup>e</sup> K102/80 <sup>e</sup>	ml ml ml

SERVITUDES/LEASEHOLD AREAS				
SURVEY RECORD	DIAGRAM NO.	DESCRIPTION	DEED /s	II
E. 3104/85	2418/86	The lines a'b', c'd', e'f', g'h', j'k' & l'm' represents the centre lines of an E.P.R.S 47m wide	K798/87	OK

THE FOLLOWING DEDUCTIONS HAVE BEEN MADE FROM THIS DIAGRAM.				
SURVEY RECORD	DIAG. NO.	SUBDIVISION	AREA	DEED / T
E. 2538/6	9009/67	Plot 1.	52.1483	13510/68
				10435/88
				Remainder Morgan

Figure 3



## SERVITUDE DIAGRAM

OFFICE COPY

SIDES Metres		ANGLES OF DIRECTION		CO-ORDINATES Y System : WG 23 X		S.G. No.
		Constants:		0,00	+3 000 000,00	6626/2007
AB	2460,61	34 02 14	A	- 40 102,87	+ 506 441,73	Approved <i>[Signature]</i> for SURVEYOR- GENERAL 4-12-2007
BC	12168,10	28 29 32	B	- 38 725,59	+ 508 480,77	
			C	- 32 920,92	+ 519 175,09	
CROSSROADS GABRIELSBAKEN		156	Δ	- 39 811,02	+ 513 039,53	
		159	Δ	- 30 037,49	+ 511 332,37	

## BEACON DESCRIPTIONS

A,B,C : 16mm Iron peg

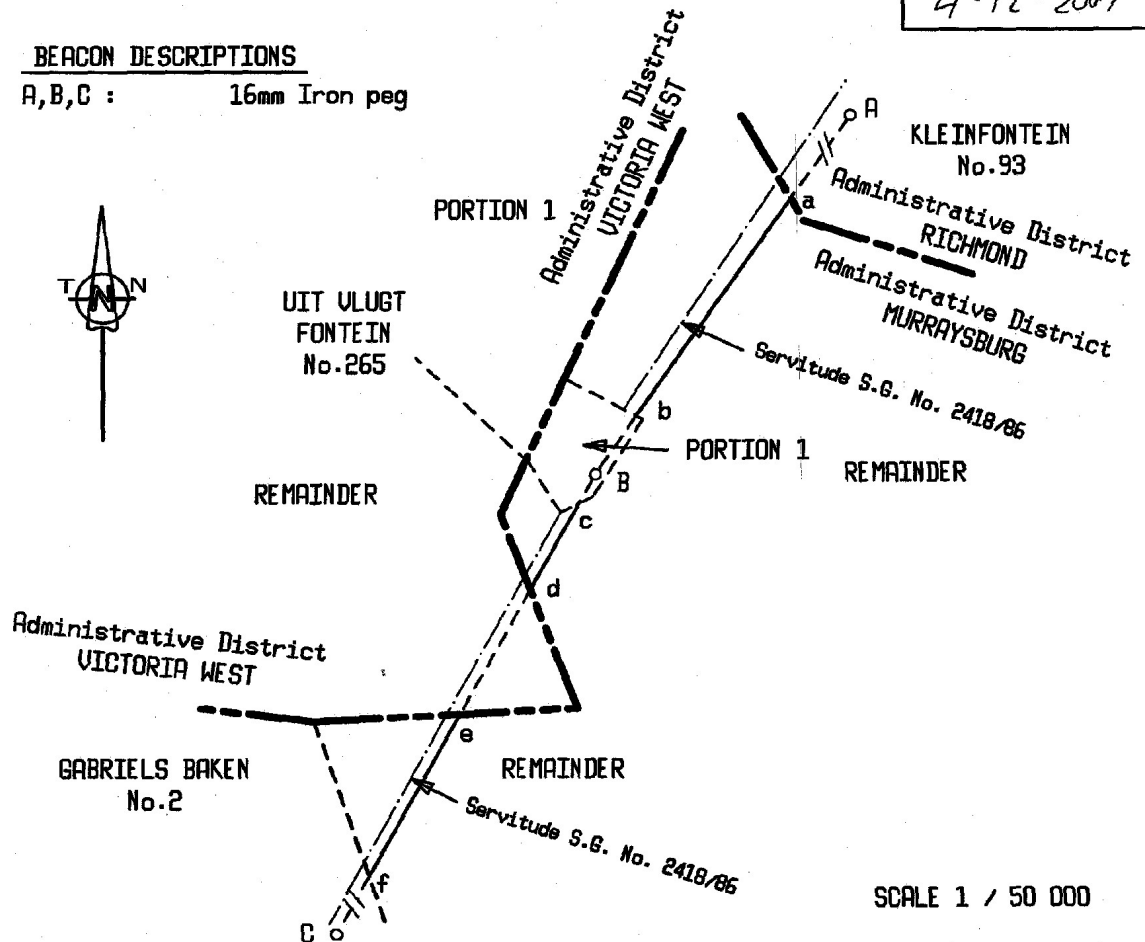

The Lines a b , c d and e f represent the centre line of a Electric Power Transmission Servitude 55,00 metres wide over

Remainder of The farm SCHIETKUIL No. 3

Administrative District : MURRAYSBURG

Province : Western Cape

Surveyed in April 2007 by me

(H.T. NDHLOVU) (PLS 1058)  
Professional Land Surveyor

This diagram is annexed to  
Deed of Servitude No.

d.d.k 236/2009

i.f.o

Registrar of Deeds

The original diagram is  
S.G. No. 3/1889

Transfer  
Grant Mu.Q.2-6

File Murbg.3 V.1

S.R. No. E2796/2007

LPI C0520000

Comp.

Gen Plan

SERVITUDE DIAGRAM

6626/2007

EXEMPT FROM PROVISIONS OF ACT  
70 OF 1970

SECTION 3(a)

EXEMPT FROM PROVISIONS OF  
CHAPTER III OF ORD. 15/1985

S